

HHA | SINGLE ACTING HOLLOW PISTON ALUMINUM CYLINDERS



Capacities from 20 to 57 tons

Stroke lengths from 2.01 to 4.14 inches

Working pressure 10000 psi

- ▶ Lightweight aluminum cylinders for applications where weight and portability are of prime importance
- ▶ Single acting, spring assisted return
- ▶ Hollow piston design for pulling, pressing and tensioning applications
- ▶ Hard anodized piston rod and cylinder for corrosion resistance and increased durability
- ▶ Steel base plate to protect cylinder body
- ▶ Low friction bearing surfaces
- ▶ Anti-extrusion seals for improved performance at high pressures
- ▶ Grooved saddles fitted as standard on all models.
- ▶ Optional piston rod saddles listed on pages 24 and 25

*see pages 24 and 25

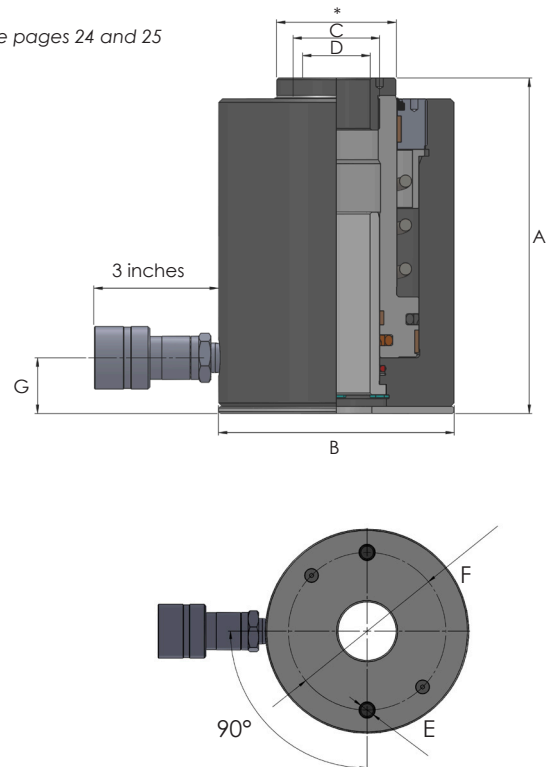

Model number	Capacity (tons)	Stroke (in)	Oil capacity (in³)	Cylinder eff. area (in²)	Weight (lbs)
HHA182	20	2.01	7.87	3.91	7.9
HHA372	41	2.01	16.23	8.08	15.9
HHA504	57	4.14	46.67	11.28	29.5

Dimensions (in) (unless otherwise stated)						
A	B	C	D	E	F	G
6.9	3.86	1.77	1.02	M8x10	2.6	1.02
7.6	5.36	2.72	1.54	M10x15	4.14	1.26
11.03	6.3	3.11	2.01	M10x15	5.13	1.54

Note: If specifying this cylinder for use with the SLF and SLV synchronous lifting systems and associated mounting kit, please consider the increase in dimension A (closed height), see pages 43 and 47.